

Fable Collection

DESIGNED IN 2024

ASSEMBLY NOTES | REV 01

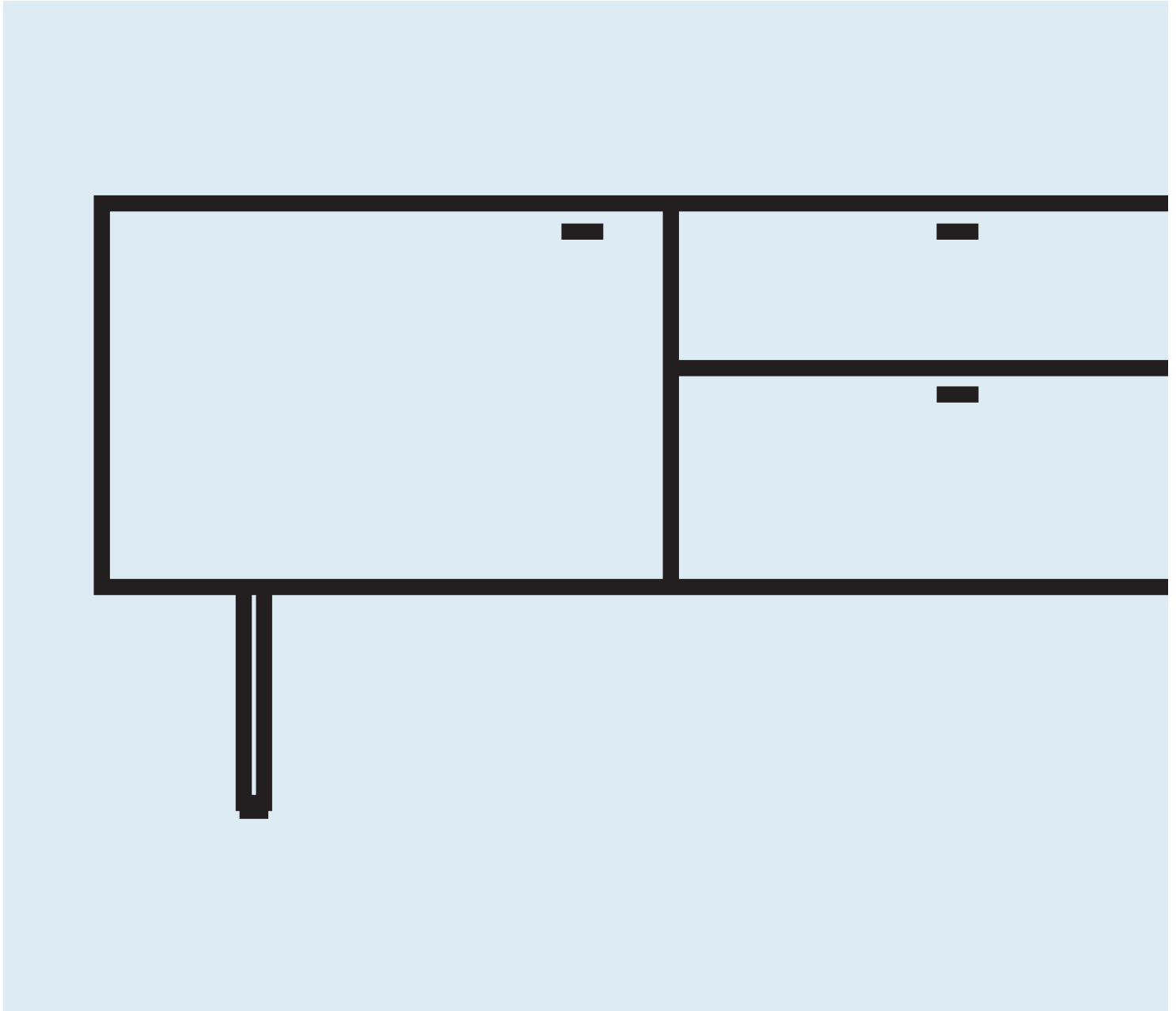
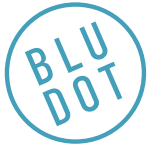

NEED A HAND?

Contact us at service@bludot.com or
844.425.8368 for assistance.

@BLUDOT

We design all our pieces in our Minneapolis studio. Follow
along on Instagram for some sneak peeks into the process.

Parts & Hardware

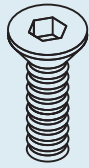

QTY Pt. 1683 16

M6x16mm

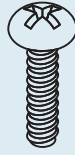

QTY Pt.1116 8

M3x15mm



QTY Pt. 1220 4

#4x25mm

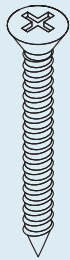

QTY Pt. 1221 4

#4x35mm

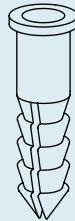

QTY Pt. 8058 4

Wall Anchor



QTY Pt. 9035 1

M4 Wrench

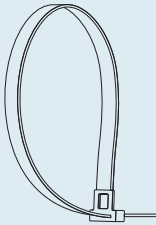

QTY Pt. 8042 2

Anti-tip Strap

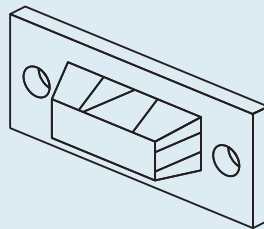

QTY Pt. 8041 4

Anti-tip Bracket

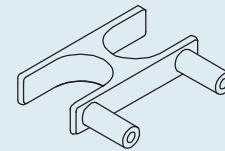

QTY 4*

Handle

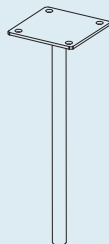

QTY 4

Leg

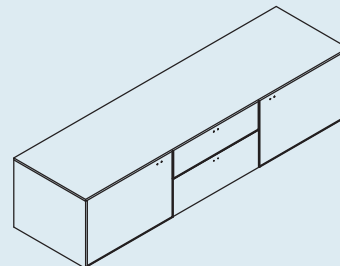

QTY 1

Case

*Handle quantity is dependent on silhouette. Each handle is paired with two Pt. 1116.

Step 01

INSTALL THE LEGS.

On a soft surface like a blanket or rug, place the case on its back or upside-down.

Install the legs using the provided hardware.

Have a second person help rotate upright while being careful not to use the legs as a pivot point.

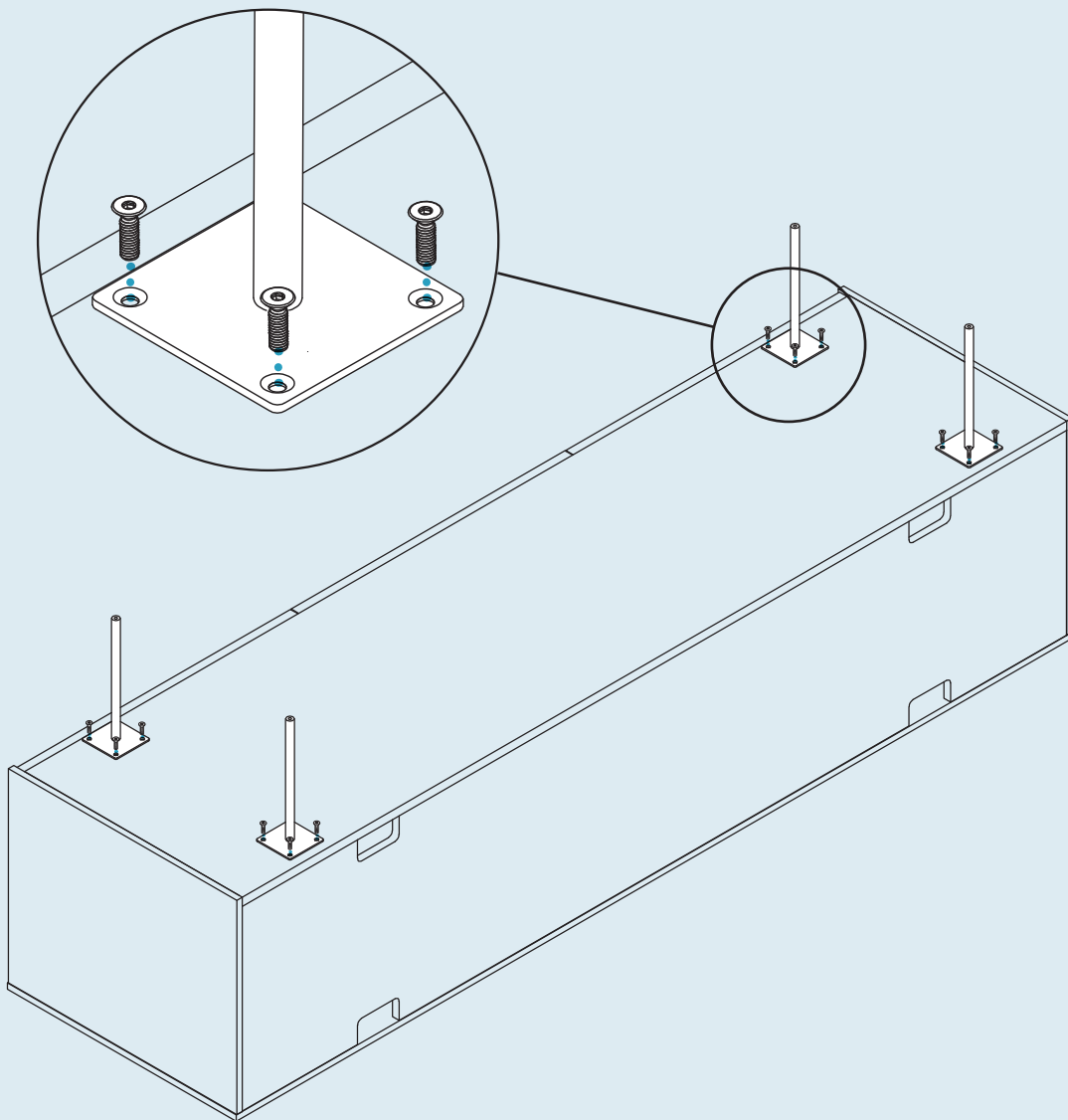

PT. 1683 X 16

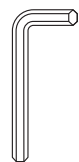

PT. 9035 X 1

Step 02

ATTACHING THE HANDLES.

Attach the handles using the provided hardware.

Note: Slight fraying of the leather around the mounting holes is normal and will get covered by the handles.

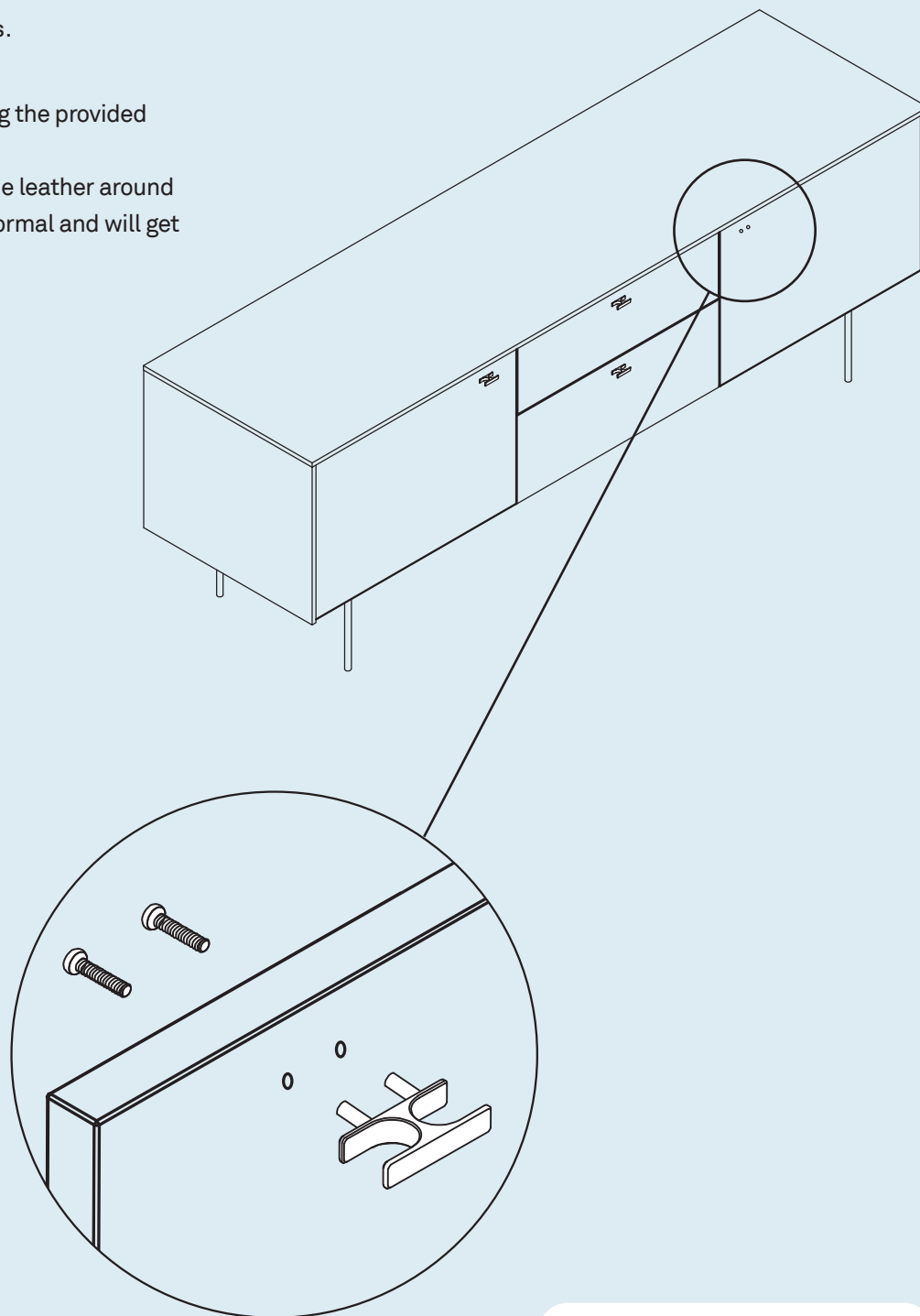

PT. 1116 x 8*

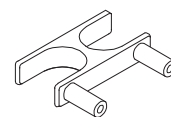

Handle x 4*

*Handle quantity is dependent on silhouette. Each handle is paired with two Pt. 1116.

Step 03

Anti-Tip Kit.

Use the Anti-Tip Kit to prevent injury from furniture tip over.

1) Brackets must be installed to top panel of case. In order to prevent damage, it is recommended that 3/32" pilot holes be drilled prior to installation.

2) Install anti-tip brackets to wall stud 1-inch below case top panel height. Or use the provided drywall anchors by drilling a 3/16" hole prior to installation of the anchor. **Consult a local hardware professional for your specific wall type.**

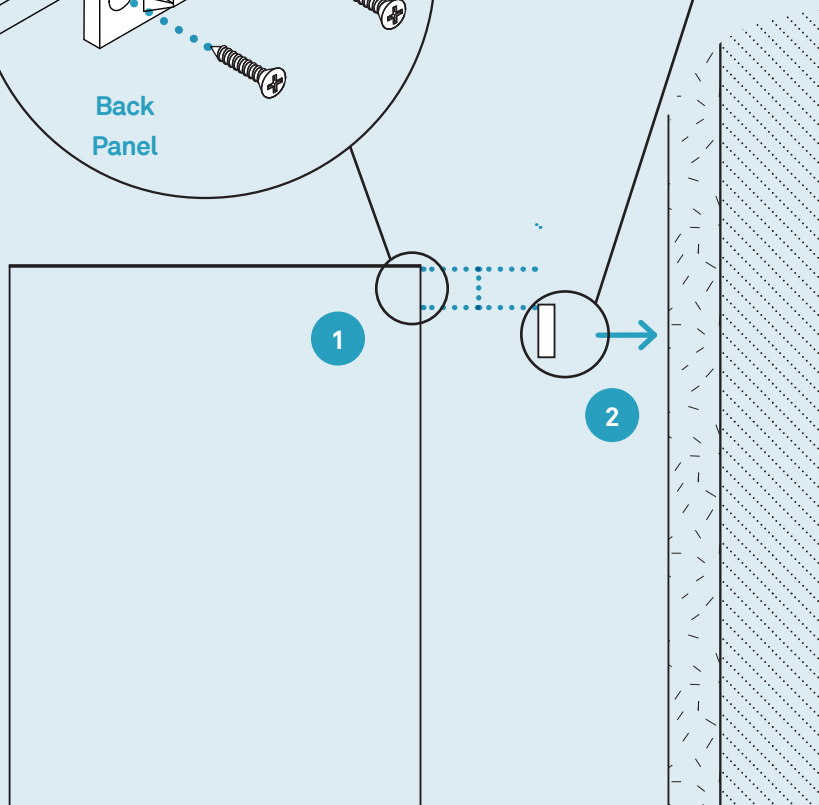
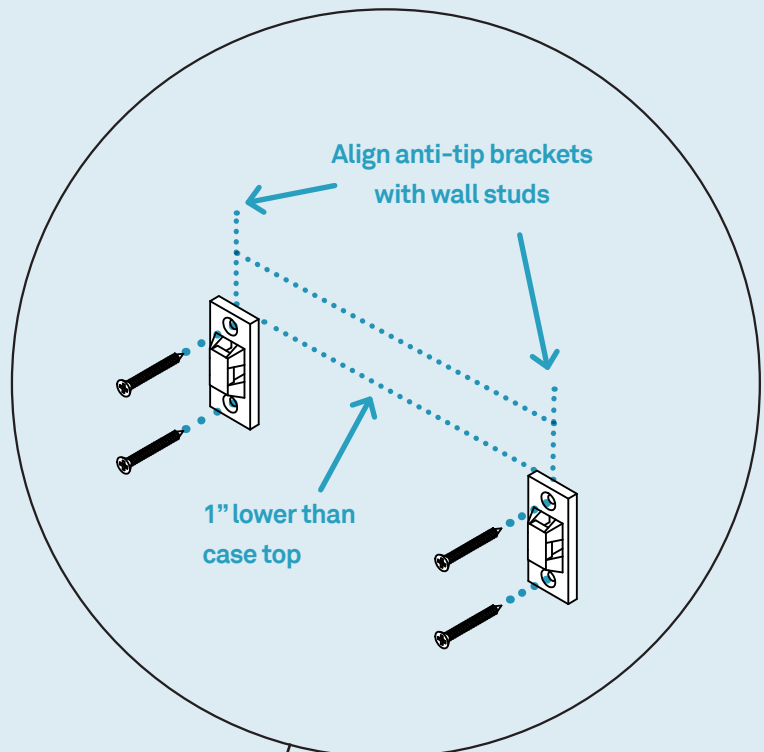
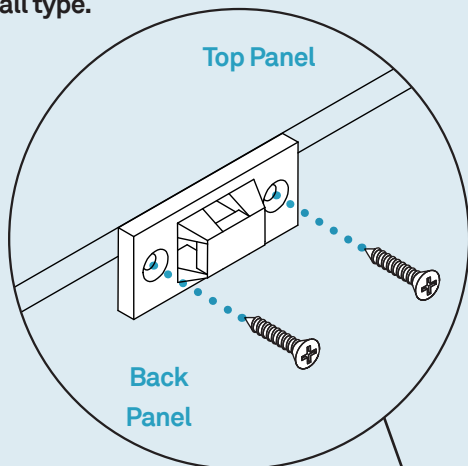

PT. 1220 X 4



PT. 1221 X 4



PT. 8058 X 4

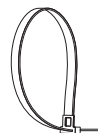

PT. 8042 X 2

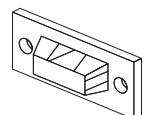

PT. 8041 X 4

Step 04

SECURE THE CASE.

Install and tighten the strap prior to using the product.

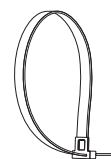
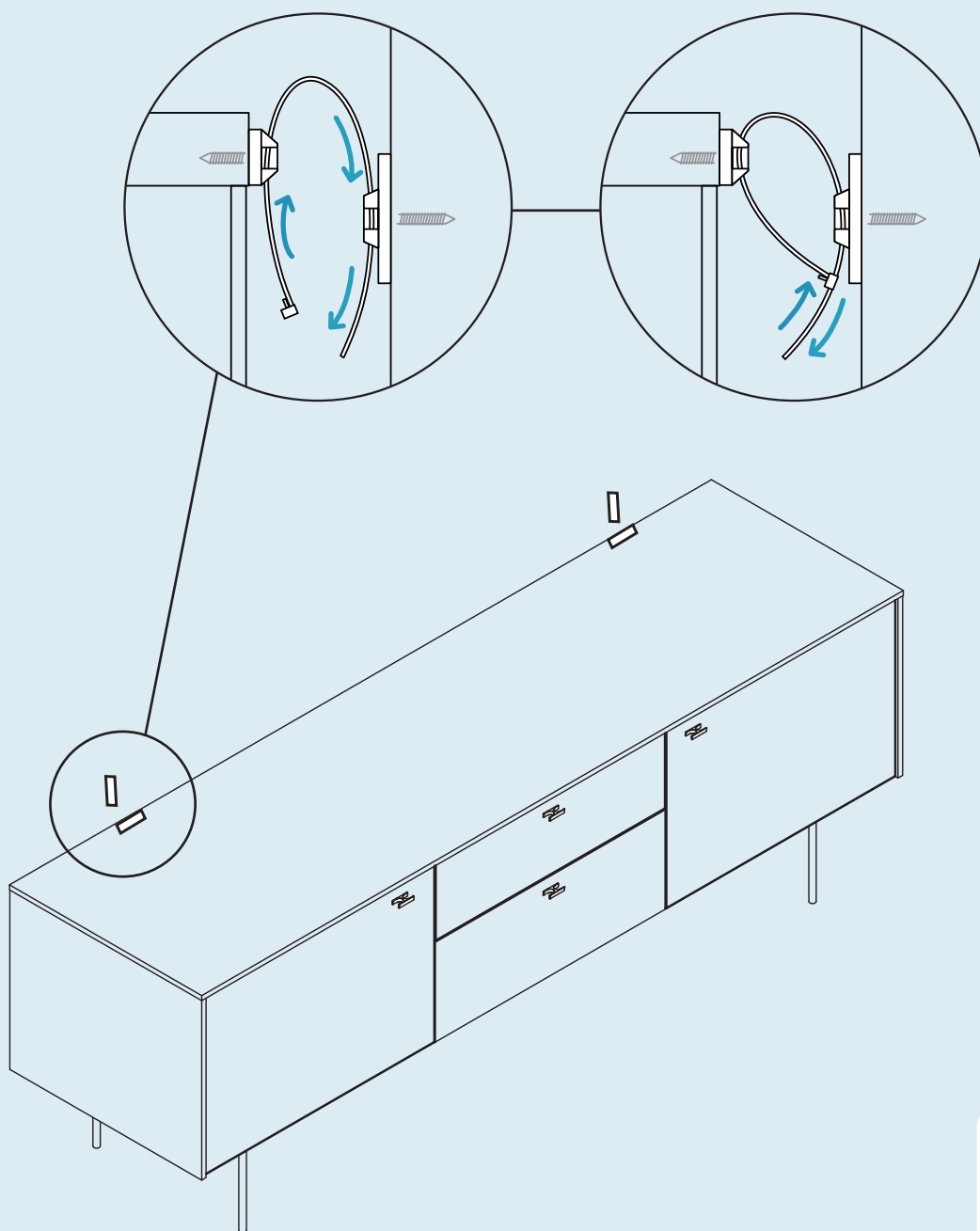

PT. 8042 X 2

Step 05



ADJUSTING HARDWARE.

Leveling the unit with the adjustable glides is a critical step in ensuring the doors and drawers are aligned. Ensure unit is level before making adjustments.

A) To remove the drawers, extend the drawer completely, squeeze both locks on the underside of the drawer while pulling the drawer out and lifting it upwards. To reinstall, lower the drawer front into place and push closed, making sure the hook on the back of the drawer slide is secured. Drawer height can be adjusted by moving the tab shown below.

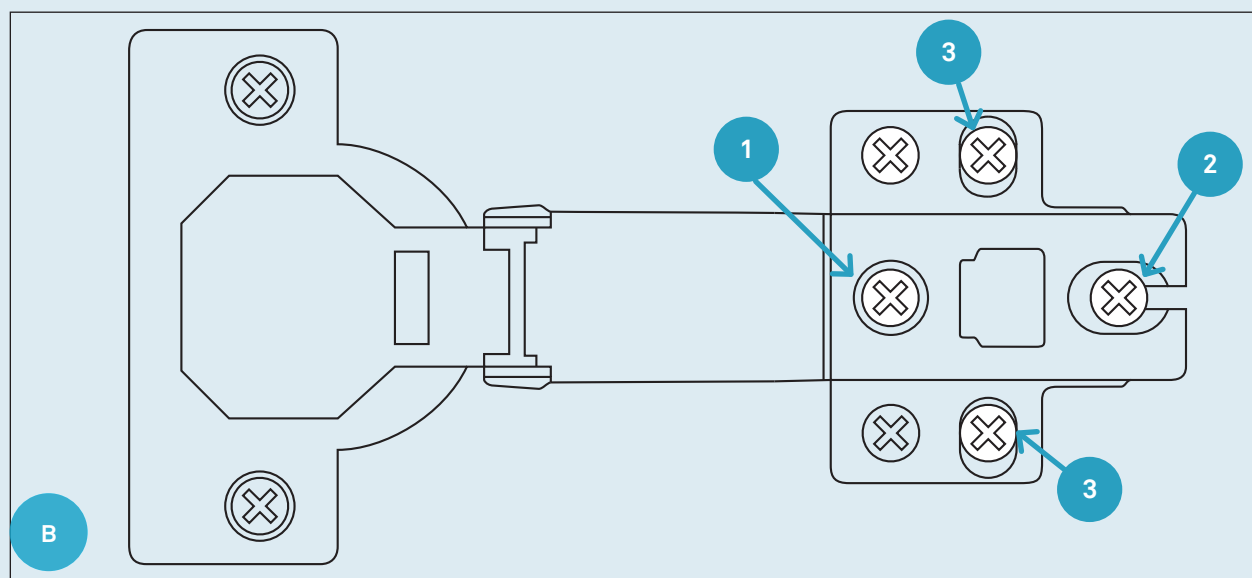
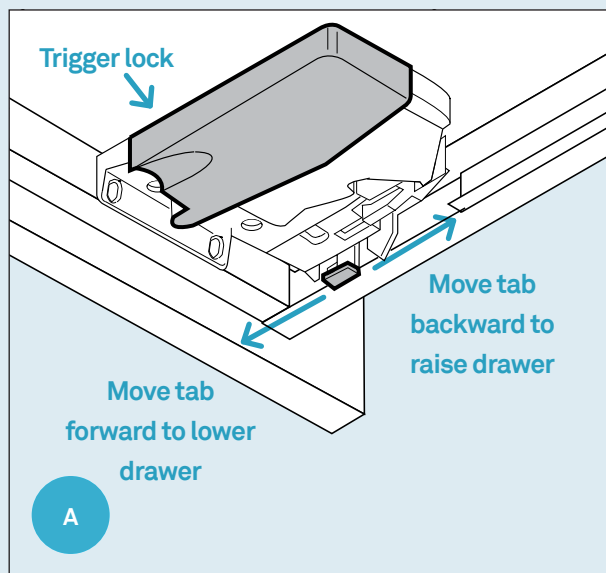
B) Hinges work in pairs. If you adjust one hinge, you will likely need to adjust the other. If the door needs adjustment from TOP TO BOTTOM, use screw #3. If door needs adjustment from SIDE TO SIDE, use screw #1. If door needs adjustment from FRONT TO BACK, use screw #2.



| ⚠ WARNING | |
|---|---|
|  | <p>Children have died from furniture tipover.</p> <p>To reduce the risk of furniture tipover:</p> <ul style="list-style-type: none">• ALWAYS install anti-tip device provided.• NEVER put a TV on this product.• NEVER allow children to stand, climb or hang on any drawers, doors, or shelves.• NEVER open more than one drawer at a time.• Place heaviest items in the lowest drawers. |
|  | <p><i>This is a permanent label.</i></p> <p><i>Do not remove!</i></p> |

Additional Information

CAUTION

This product is not intended as a clothing storage unit or dresser.

NOTE

Keep furniture out of direct sunlight and away from heat sources; excessive exposure to sunlight may cause color fading. Take care in avoiding excessive touching or rubbing the leather as natural oils from skin can accelerate discoloration. The leather may have slight color variation from piece to piece that will even out over time. The natural beauty of the leather has an inherent delicateness, so slight scratches or distressing may occur with use. In the event a light scratch does happen, use the included cleaning cloth to gently buff the scratches.

MOORE AND GILES CLEANING CLOTH

No lengthy prep or clean-up, no extra cleaning supplies to keep track of, and no multi-step process to follow. The microfiber cloth is saturated with a proprietary and gentle blend of waxes and oils; just a few quick strokes of the cloth will buff everyday scratches and abrasions back into the leather and your favorite product is left looking unblemished and refreshed. DO NOT press too hard as swirls and scratches can occur. If that does happen, use the cloth again to gently buff them out.

WOOD CLEANING

Clean with a slightly damp, soft cloth. To remove dirt and fingerprints, use a quality cleaner formulated for wood furniture. Wipe completely dry with a soft cloth in the direction of the wood grain.

